

**NOTE**  
**PROPOSED HIGHWAY ALIGNMENT BASED UPON**  
**DRAWING INFORMATION PRODUCED BY PJA**  
**REF 06842/D**  
**DRAWING NUMBER 06842-CI-D-0100 REV P07**  
**RECEIVED 03/05/2024**

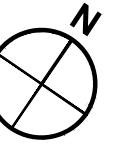

Inset A - Existing Footway and Crossing Arrangement.

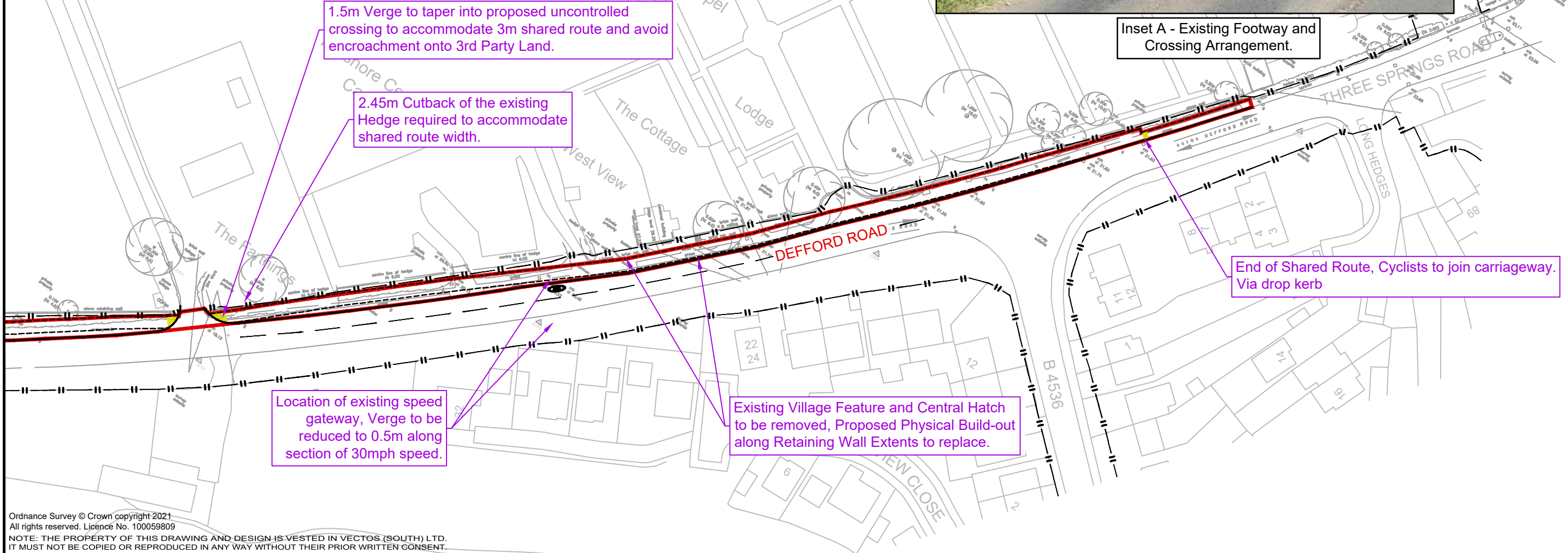

1.5m Verge to taper into proposed uncontrolled crossing to accommodate 3m shared route and avoid encroachment onto 3rd Party Land.

2.45m Cutback of the existing Hedge required to accommodate shared route width.

Location of existing speed gateway, Verge to be reduced to 0.5m along section of 30mph speed.

Existing Village Feature and Central Hatch to be removed, Proposed Physical Build-out along Retaining Wall Extends to replace.

End of Shared Route, Cyclists to join carriageway. Via drop kerb

Ordnance Survey © Crown copyright 2021  
 All rights reserved. Licence No. 100059809  
 NOTE: THE PROPERTY OF THIS DRAWING AND DESIGN IS VESTED IN VECTOS (SOUTH) LTD.  
 IT MUST NOT BE COPIED OR REPRODUCED IN ANY WAY WITHOUT THEIR PRIOR WRITTEN CONSENT.

REV.	DETAILS	DRAWN	CHECKED	DATE
A	PROPOSED HIGHWAY ALIGNMENT BASED UPON DRAWING INFORMATION PRODUCED BY PJA SHOWN	SCJ	IS	03/05/24

**Notes:**  
 1. This is not a construction drawing and is intended for illustrative purposes only.  
 2. White lining is indicative only.

**Legend:**  
 - - - ADOPTED HIGHWAY BOUNDARY  
 — APPLICATION SITE BOUNDARY

**INFORMATION ONLY**

**Orchard Farm, Pershore**

**Proposed Footway Alignment**  
**End of Shared Route**

**Formula Land**

DRAWN: KR	CHECKED: IS	DATE: 13.02.23	SCALES: 1:1000 at A3
-----------	-------------	----------------	----------------------

DRAWING NUMBER: 227119-PD14.3	REVISION: A
-------------------------------	-------------